

# Sharkward Wireless Fixture Control

## for Office Lighting



Sharkward Wireless Fixture Control



Sharkward Fixture Sensor



Sharkward Wireless Control

## Sensing a smart world with Sharkward

### Maximize energy savings

- Save energy at each fixture
- Use only the light you need across any space

### Personal control

- Wireless fixture control provides each occupant the ability to adjust the light to suit the task at hand

### Eliminate design and installation hassle

- Just count the fixtures
- Works with any 0–10V fixture
- No control wiring between fixtures



Fixture control mounted above ceiling

Sensor as seen below ceiling

# Maximize energy savings

Each wireless individual fixture supports three control strategies for maximum energy savings and enhanced comfort

## Occupancy sensing

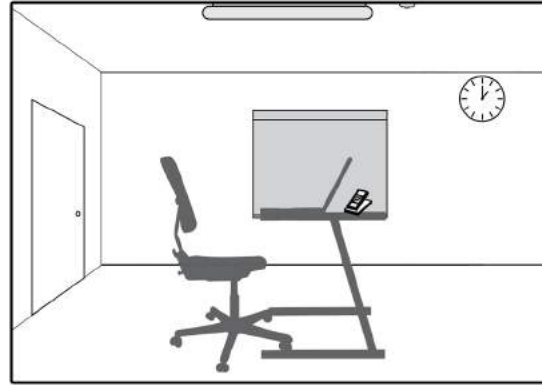

Turns individual fixtures on when a person occupies an area and turns them off when a person leaves the area.

## Daylight harvesting



Dims/brightens the fixture based on available daylight

## Personal wireless control



Provides the ability to lower lights with a simple button press

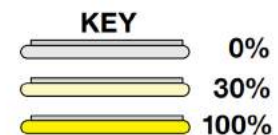

## Combined savings across a space

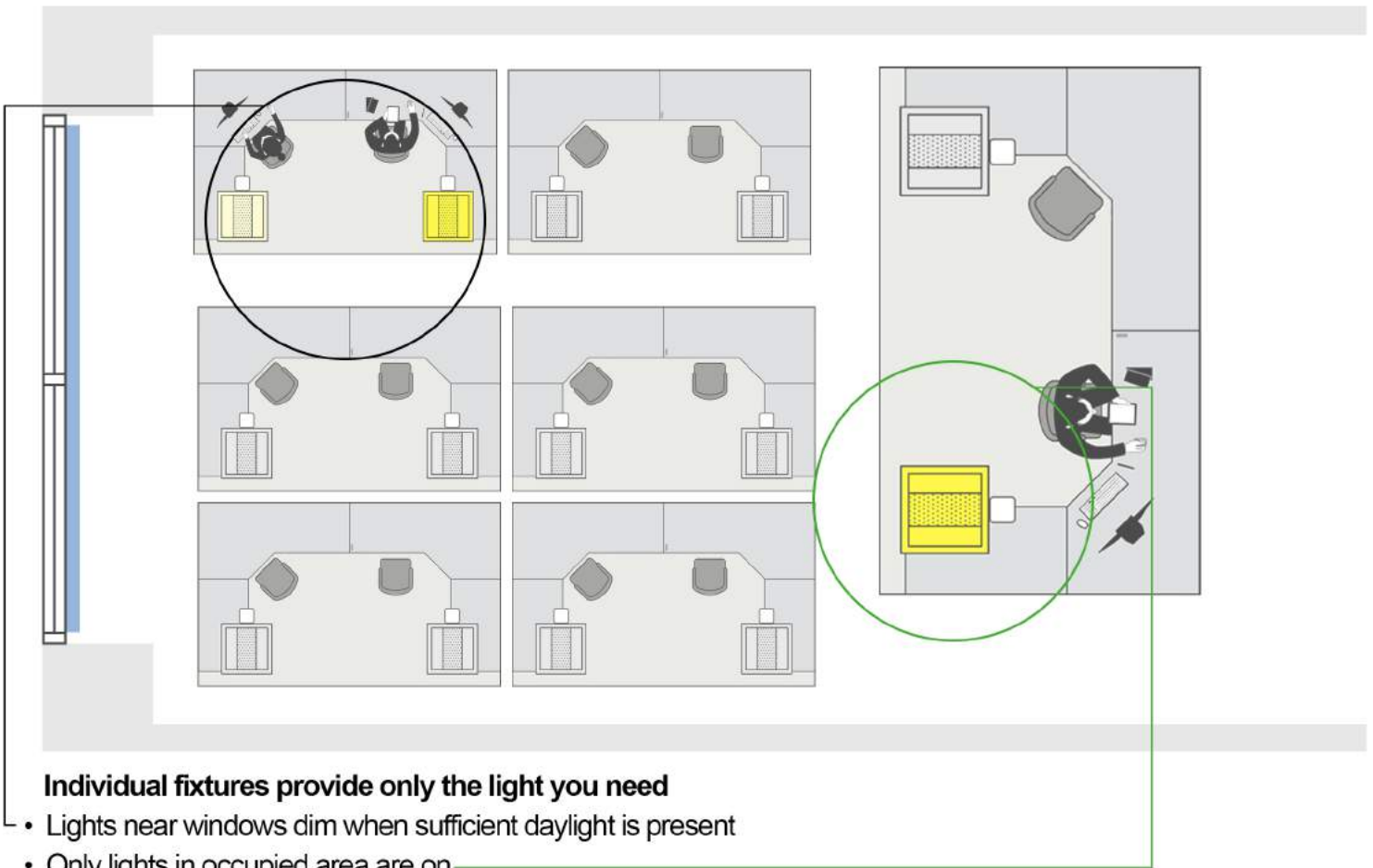

## Enhance Comfort

With Sharkward Wireless Remote Control, each occupant can adjust the lights to suit their needs.



Handheld the remote:  
Dim the lights to 30% to  
reduce glare on screen

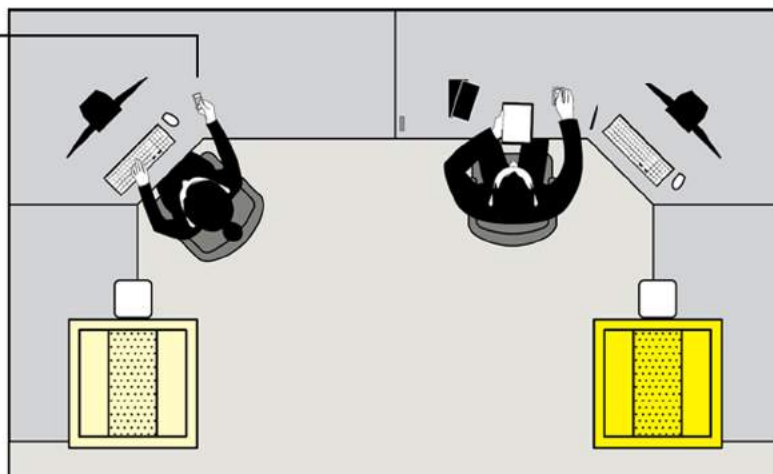

Wall-Mounted Remote:  
add a new point of control anywhere  
with absolutely no wires

# Eliminate design hassle

## This simple solution couldn't be easier

### Just count the number of fixtures

- Quickly and easily estimate jobs—no need to know the existing wiring

### The wireless fixture control works with any 0–10V fixture

- Automatically adapts to both sink and source ballasts and drivers
- UL approved to be installed at the job site or at the fixture OEM

## Out of the box code compliance

### Just install the control, attach the sensor, and meet the following codes:

- ASHRAE 90.1-2016
- Title 24-2020

For specific commercial building code lighting requirements in your state, please visit

[www.sharkward.com](http://www.sharkward.com) or contact [info@sharkward.com](mailto:info@sharkward.com)

## Flexibility when you need it

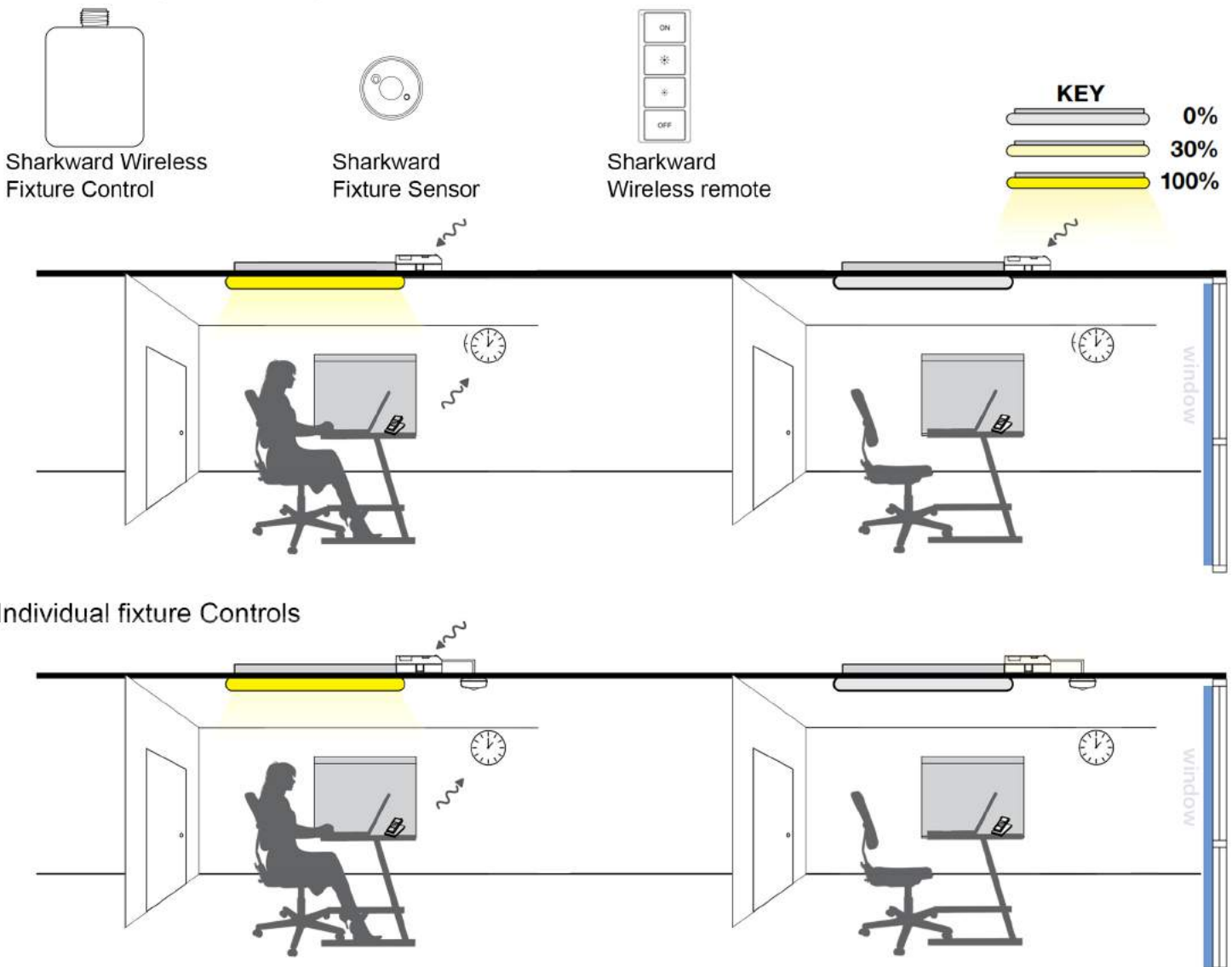

Individual fixture controls and sensors provide granular control each sharkward sensor has daylight harvesting function.

# Simplify installation—no control wiring between fixtures

- 1 Mount control to a fixture or junction box through a standard knockout



- 2 Mount and connect the sensor through the ceiling tile



- 3 Assign a wireless remote to the fixture (optional)

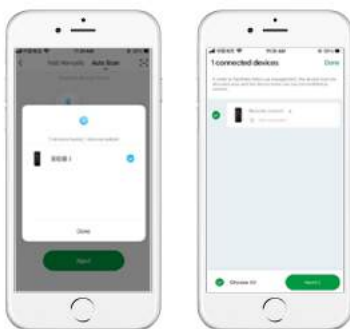

- Press and Hold the "ON" button and "OFF" for 3 seconds until the green light starts to blink.



- You can scan and add Remote Control by Sharkward APP.

# A solution for every space

Sharkward can meet the needs of any application within your building

## Individual fixture dimming



Wireless fixture control and  
Wireless Remote control



Open office



Cafeteria

## Single zone switching



Power pack junction box mounted reply  
and Wireless Occupancy Sensor with  
Daylight Harvesting Function



Basic conference room



Restroom



Wireless switch and occupancy sensor



Private office

## Multi-zone Preset Control



Bluetooth Sig Mesh Gateway



Executive conference room

# Features and benefits



**BRI-PP01**

L: 2.9" (72.5mm)  
W: 1.6" (41.5mm)  
H: 1.1" (28mm)

## Sharkward wireless fixture control

- Real-Time Measurement and Verification of Energy Savings
- Simple and Low-Cost Installation
- Compatibility with 12VDC AUX power
- Output for CCT and Dimming
- Bluetooth Mesh

### Available model numbers:

BRI-PP01: 0-10V power pack

ANT-1C-BLE: Daylight sensor for Panel Light

ANT-4A-BLE: Daylight sensor for Troffer



**ANT-1C-BLE**

L: 1.98" (50.4mm)  
W: 0.62" (15.76mm)  
H: 1.4" (35.6mm)

## Sharkward Fixture Sensor

- Localized Lighting Control
- Bluetooth Low Energy
- Occupancy/Vacancy/Manual
- Dual 0-10V Channel
- Daylight Harvesting
- Room and Zone Control



**ANT-4A-BLE**

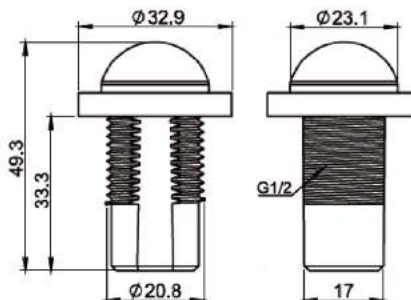

Coverage Side View

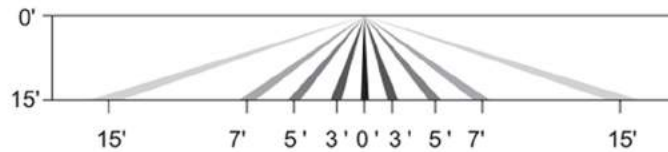

Coverage Top View

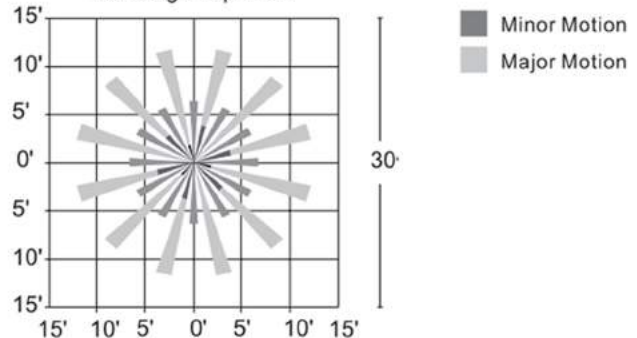

BRI-WS203



### Sharkward wireless fixture control

- Localized Microprocessor Control
- Programmable
- Code Compliant
- Simple and Low-cost Installation
- Standards-Based Networking and Security
- Minimal Air-time

L: 3.15" (72mm)  
W: 1.38" (35mm)  
H: 0.53" (13.5mm)

### Available model numbers:

BRI-WS203: Wireless Remote Control  
SKGWBLE01: BLE SIG Mesh Gateway



SKGWBLE01

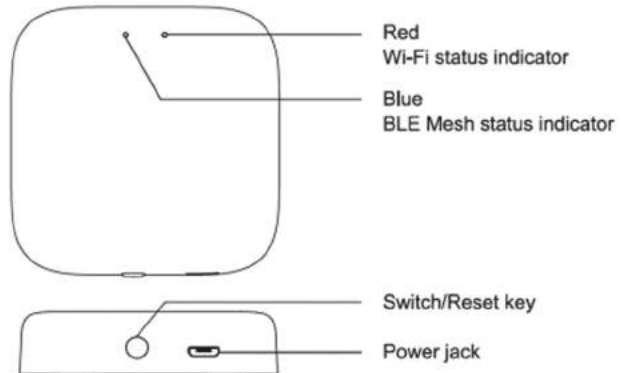

Product name	BLEMESH (SIG) Gateway
Model number	SKGWBLE01
Input	5V=1A (Direct current)
Working temperature	-10°C~55°C
Working humidity	10%~90% RH (no condensation)
Dimensions	60.5x60.5x16.1mm
Wireless technology	Wi-Fi 802.11b/g/n BLEMESH (SIG)
Radio frequency	2.400-2.4835GHz
Transmit power	Wi-Fi 21dBm Bluetooth 7dBm
Net weight	34g